

## High Accuracy - Current Transformer

### Features:

- ◆ Primary Current Range from 50A to 150A
- ◆ Operating Frequency 50 / 60Hz
- ◆ Class 1 Accuracy (5% to 120% of rated primary current)
- ◆ Rated Burden  $R_L = 33\Omega$
- ◆ Dielectric withstand Voltage 4kVrms
- ◆ Operating temperature range  $-40^\circ\text{C}$  to  $+85^\circ\text{C}$
- ◆ Encapsulated & PCB Mountable
- ◆ All materials are UL approved



### Mechanical Drawing

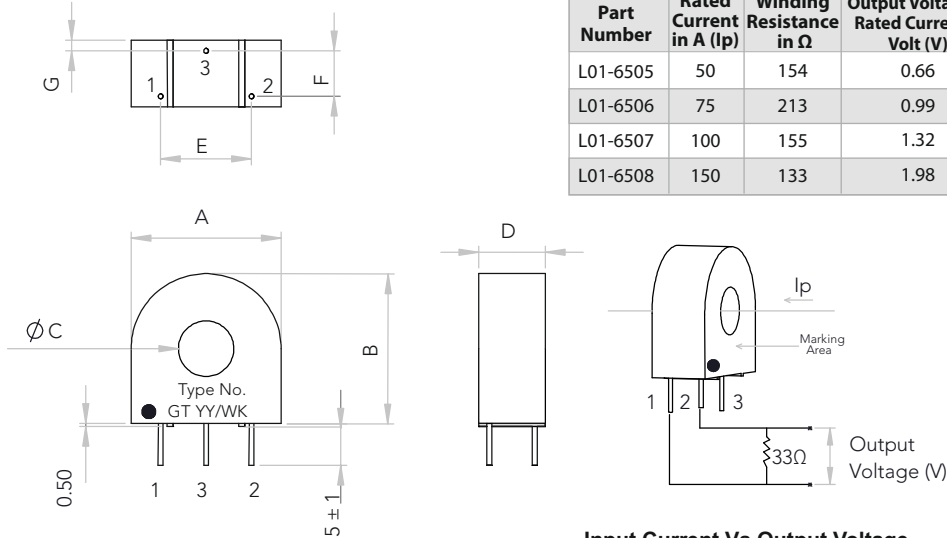

### Electrical Specification @ 20°C

Part Number	Rated Current in A (I <sub>p</sub> )	Winding Resistance in Ω	Output Voltage @ Rated Current in Volt (V)	Dimensions							
				A	B	ØC	D	E	F	G	Pins (Ø)
L01-6505	50	154	0.66	23.80	23.80	9.50	11.20	15.24	7.62	1.75	0.80
L01-6506	75	213	0.99	30.20	30.20	11.40	14.30	20.32	10.16	2.08	1.00
L01-6507	100	155	1.32	34.90	34.90	14.60	14.30	25.40	10.16	2.08	1.00
L01-6508	150	133	1.98	38.10	38.10	14.60	15.90	33.00	10.16	2.85	1.00

### Note:

- ◆ Dimension Unit : mm
- ◆ Dimension Tolerance :  $\pm 0.25\text{mm}$  (Unless specified)
- ◆ Pin Pitch Tolerance :  $\pm 0.1\text{mm}$
- ◆ Pin 3 for Mechanical Support only

### Input Current Vs Output Voltage

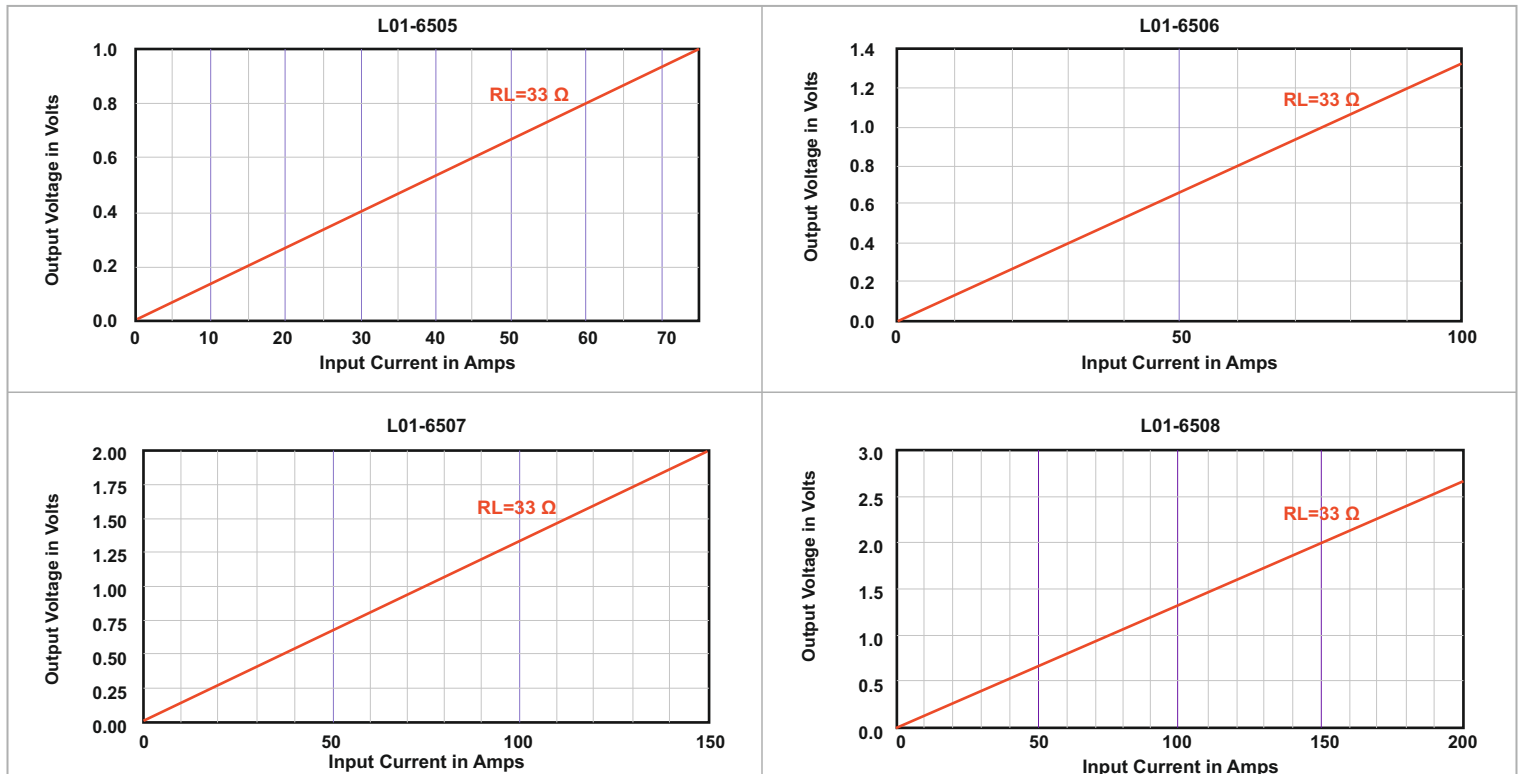

Product innovation is a part of continuous development hence specifications are subject to change without notice.

**Transforming Power into Quality!**